

# X2-R4 Series

Rocker Switches



## SPECIFICATION

Electrical Rating : 20A 125VAC/16A 250VAC(UL)  
16A 250VAC(VDE)

Mechanical life: Over 30000 cycles

Electrical life: Over 10000 cycles

Contact resistance: <20mΩ

Insulation resistance: >1000MΩ

High voltage resistance: >1500V 1 min.

Ambient temperature: Terminal side -20 to +85°C

Actuating side -20 to +55°C

Storage temperature: -30 to +80°C Max

Atmospheric humidity: Max.85%

Actuating force: 4~8N(depends on different switch function)

Flammability: UL94 V-2

Temperature rise at the terminal: Max 30°C (UL1054)

Solder ability of terminal: Max 350°C, 3s

## MATERIALS

Housing: Nylon 66

Rocker: PC & PA66

Contacts: Silver Alloy

Terminal: Brass Silver Plated

Lamp: Neon Lamp, Tungsten Lamp

Spring: SWP,SUS

Movable Arm: Brass Silver Plated



## HOW TO ORDER

**X2-R4 1 5 K K E T 0 F A**

Series      Switch Function      Rating      Housing Color      Actuator Color      Marking      Terminal Type      Lamp Voltage      Safety Approval

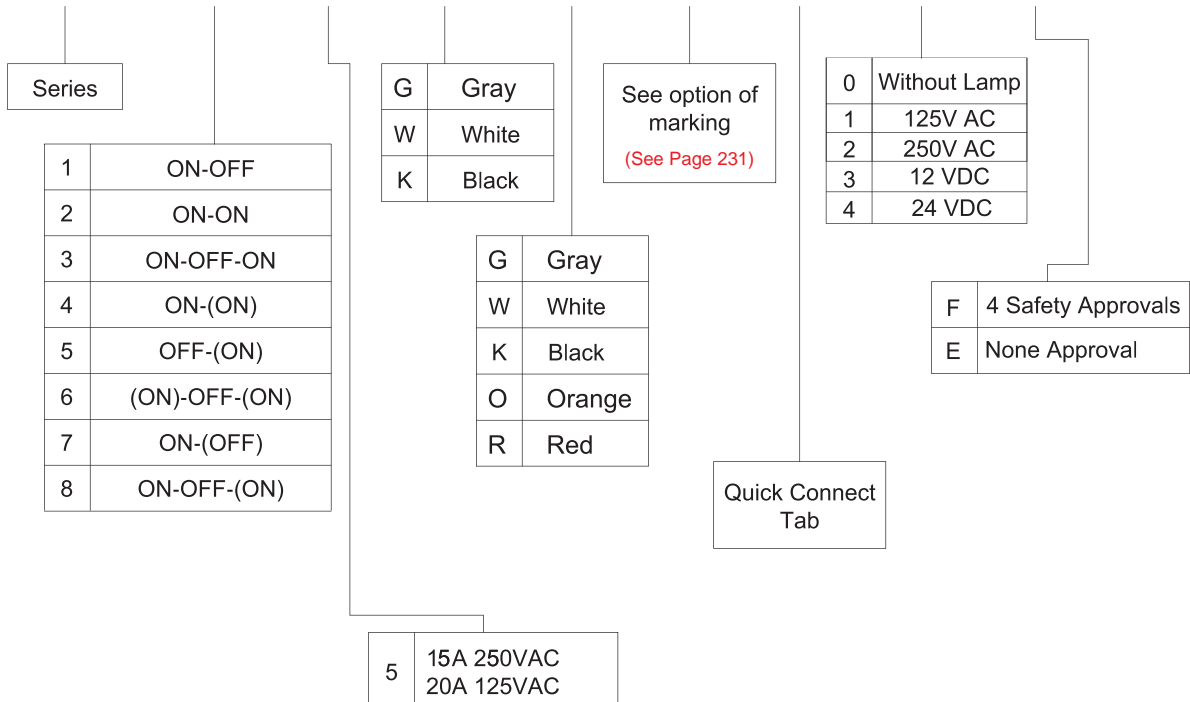

X2-R4  
Rocker Switches

## OPTIONS OF SWITCH FUNCTION / DIMENSION

Item NO	POLES & THROWS	Rocker position ( ):Momentary		
		Left	Center	Right
X2-R41	SPST	ON	None	OFF
X2-R42	SPDT	ON	None	ON
X2-R43	SPDT	ON	OFF	ON
X2-R44	SPDT	ON	None	(ON)
X2-R45	SPST	OFF	None	(ON)
X2-R46	SPDT	(ON)	OFF	(ON)
X2-R47	SPST	ON	None	(OFF)
X2-R48	SPDT	ON	OFF	(ON)
X2-R49	SPST (WITHLAMP)	ON	None	OFF

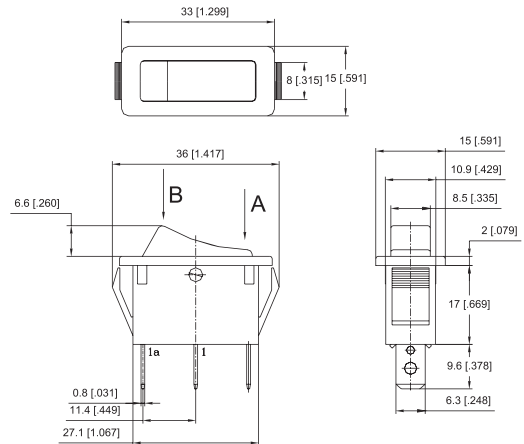

## PANEL CUT OUT

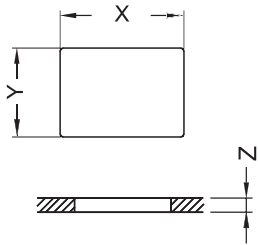

Z	Y	X
0.70~1.25	11.10~11.20	29.60~29.70
1.25~2.00	11.10~11.20	30.10~30.20
2.00~3.00	11.10~11.20	30.45~30.55

## CIRCUITS FOR SWITCH WITH LAMP

For circuit of 250V AC or 125V AC  
For circuit of 24V DC or 12V DC

